

**ITEM 7. STREET EVENTS – TEMPORARY ROAD CLOSURE – GLEBE
STREET FAIR**

TRIM RECORD NO: 2014/291692

RECOMMENDATION

It is recommended that the Committee endorse the temporary road closures for the annual Glebe Street Fair on Sunday 16 November 2014 from 2am to 11.00pm subject to the following conditions:

- (A) The Applicant must comply with the temporary road closures conditions as stipulated in Schedule B of this Agenda.
- (B) The Applicant must contact Leichhardt Police to discuss deployment of user pay police for the event.
- (C) The Applicant must contact the City's Venue Management Unit to discuss the event.
- (D) The Applicant to organise and pay for RMS Special Event Clearways.
- (E) The Applicant is to obtain a Road Occupancy Licence from the Transport Management Centre prior to commencement of the event.
- (F) The Applicant must provide a telephone number of the supervisor responsible for the proposed event and include contact details in the notification letters to be distributed to affected stakeholders.
- (G) The Applicant must contact Sydney Buses and arrange and pay for the rerouting of bus services around the closures, the temporary relocation of bus stops and any additional staff required.

DECISION

BACKGROUND

Glebe Chamber of Commerce had applied for temporary road closures to hold the annual Glebe Street Fair on Sunday 16 November 2014 from 2am to 11pm.

This Item was deferred at the September meeting to allow the Applicant to:

- prepare and submit a Traffic Management Plan (TMP) to the RMS for review and approval;
- seek approval from the Transport Management Centre (TMC) for the proposed Special Event Clearways; and
- update the Traffic Control Plan (TCP) to address concerns raised by the RMS with regard to the need for advanced warning signage on approach to the road closures; information on the associated detour routes for affected side streets; further detail on

managing the operation of affected traffic signals; and to reflect the feedback provided by the TMC about the proposed Special Event Clearways.

These outstanding issues have now been resolved.

COMMENTS

This year will have the theme ***Lighten Up*** which will be incorporated into all the marketing, entertainment and activities on the day including a world record breaking attempt, umbrella art and interactive street performances with over 200 stalls and an estimated 120,000 visitors.

Temporary Road Closures – Sunday 16 November 2014, 2am to 11pm

- Glebe Point Road between Parramatta Road and Bridge Street;
- Francis Street between Glebe Point Road and Grose Street;
- Cowper Street between Glebe Point Road and Campbell Lane;
- Norton Street between Glebe Point Road and Campbell Lane;
- St Johns Road between Derwent Lane and Campbell Lane;
- Mitchell Street between Campbell and Derwent Lanes;
- Derwent Lane from the bend to Glebe Point Road (Northern end Glebe Public School);
- Derby Place from Glebe Point Road to Derwent Lane; and
- Derwent Street to Derwent Lane, Glebe.

There are currently no other approved temporary road closures proposed to take place on the same day.

CONSULTATION

The Applicant will be required to notify affected residents and stakeholders as stipulated in Schedule B.

FINANCIAL

Not applicable as the Glebe Chamber of Commerce is a not-for-profit organisation which is exempt from fees as stipulated in the current City's Fees and Charges.

ATTACHMENTS

Street Events – Glebe Street Fair

John Gill – Engineering Traffic Officer

Road closures overview
Page 8

Parramatta Road Closure
One Traffic Control Officer shall be stationed at this point between the hours of 2am - 10.30 pm. Traffic Control Officer shall not be permitted to leave this area unattended unless relieved from duties. There shall be NO ACCESS for stall holders from Parramatta Road. The kerb side lane of Glebe Point Road is to be kept clear at all times for emergency access.

Cowper St Closure
One Traffic Control Officer shall be stationed at this point between the hours of 6.00am - 10.00 am. Traffic Control Officer shall not be permitted to leave this area unattended unless relieved from duties.

Mitchell St Road Closure (Northern & Southern)
Two Traffic Control Officers shall be stationed at east & west of Mitchell between the hours of 6.00am - 10.30 pm. Traffic Control Officers shall not be permitted to leave this area unattended unless relieved from duties.

St Johns Road Closure
Three Traffic Control Officers shall be stationed east and west on St John St between the hours of 6.30am - 10.30 pm. Traffic Control Officers shall not be permitted to leave this area unattended unless relieved from duties.

Bridge Road Closure
One Traffic Control Officer shall be stationed at this point between the hours of 2am - 10.30 pm. Traffic Control Officer shall not be permitted to leave this area unattended unless relieved from duties.

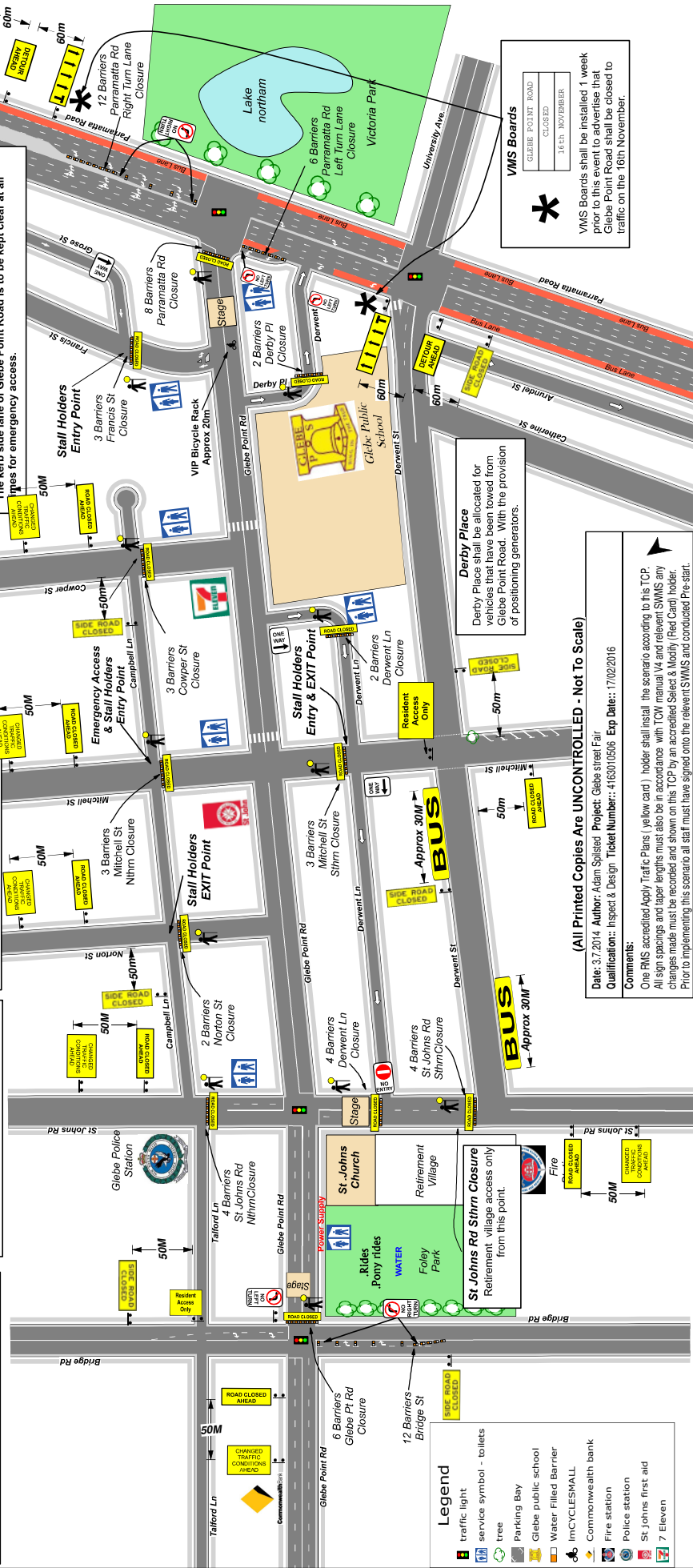

VMS Boards
GLEBE POINT ROAD
CLOSED
16th NOVEMBER

* VMS Boards shall be installed 1 week prior to this event to advertise that Glebe Point Road shall be closed to traffic on the 16th November.

(All Printed Copies Are UNCONTROLLED - Not To Scale)
Date: 3.7.2014 Author: Adam Spisited Project: Glebe street Fair
Qualification: Inspct & Design Ticket Number: 4763010506 Exp Date: 17/02/2016

Comments:
One RMS accredited Apply Traffic Plans (yellow card) holder shall install the scenario according to this TCP. All sign spacings and taper lengths must also be in accordance with TCM manual V4 and relevant SWMS any changes made must be recorded and shown on this TCP by an accredited Signet & Modify (Red Card) holder. Prior to implementing this scenario at site must have signed onto the relevant SWMS and conducted Pre-start.

- Legend**
- traffic light
 - service symbol - toilets
 - tree
 - Parking Bay
 - glebe public school
 - Water Filled Barrier
 - INCYCLESWALL
 - Commonwealth bank
 - Fire station
 - Police station
 - St Johns first aid
 - 7 Eleven

